

CARCAMP

Menabo Group

INSTALLATION AND USER MANUAL

AURORA

COMPATIBLE MODELS

AURORA 2+ · AURORA 3



C O N T E N T S

01	Warranty	p. 3
02	Safety warnings	p. 4
03	Box contents	p. 8
04	Ground assembly	p. 9
05	Tent orientation on the vehicle	p. 12
06	Attaching tent to the vehicle	p. 13
07	Using the ladder	p. 14
08	Opening the tent on the vehicle	p. 18
09	Closing the tent	p. 22
10	Storage	p. 24
11	Maintenance	p. 25
12	Memory & Feedback	p. 26

Carcamp Roof Tent Warranty

2-Year Warranty

For two years from the date of delivery, Carcamp will repair or replace defective parts at its sole discretion, free of charge when the work is carried out at our premises. Any off-site work will be charged at cost, including travel expenses and mileage costs.

Any defects must be reported within 15 days of product delivery.

Our warranty does not cover the following:

- UV damage to the fabric.
- Damage caused by normal wear and tear, or cosmetic imperfections resulting from use, such as fading of vinyl windows, scratches or dents on the tent shell, etc.
- Damage caused by the customer, including misuse, accidents, abuse, etc.
- Damage resulting from force majeure and/or natural events.
- Damage resulting from cosmetic or structural modifications not carried out by Carcamp.

Additional conditions

- This warranty applies only to customers who purchased the product directly from Carcamp or from an authorised dealer. It does not cover second-hand purchases.
- Although the warranty covers products sold through authorised dealers, customers who purchased Carcamp products through a dealer must submit any after-sales requests through the dealer from whom they purchased the product.
- The warranty does not cover any shipping costs for products to be repaired or replaced.

NB. Any tampering with or modification of the product by personnel not authorised by Carcamp will void the warranty.

Carcamp products are designed to provide shelter and comfort while camping in complete freedom and during vehicle-based outdoor activities.

Every product sold by Carcamp has undergone rigorous use testing to determine its durability and improve its performance.

However, correct use of the products is essential to ensure their longevity and the safety of you and those around you.

We recommend getting familiar with the products gradually, building up your awareness of all the variables this sector involves.

Improper use can result in serious injury to yourself and to those around you.

Before each trip with your Carcamp products, always carefully assess the weather conditions to avoid unpleasant or dangerous situations. Lastly, always carry out the periodic maintenance set out in this manual to keep the equipment in good condition.

Carry out a thorough check of the mounting support and verify that the vehicle can bear the dynamic load (i.e. the weight of the tent when closed).

Be aware of the normal increase in fuel consumption and driving noise; since the vehicle's aerodynamics are affected by mounting your roof tent, side wind gusts will also be more noticeable.

If the vehicle is small and light, it will handle differently around bends and you will need to adjust your driving style slightly.

Never load any objects on top of the roof tent.

Never exceed the speed limit of 130 km/h or 80 mph.

Always park the vehicle on level ground; use a spirit level to make this easier. If the ground is particularly uneven, use levelling wedges specifically designed for the purpose.

Remember that you'll be more comfortable if your head is slightly higher than your feet when lying inside your roof tent.

Read the chapter on the ladder before using the product.

Before using the product, check that the local regulations at the location where you have decided to stop do not restrict its use.

NB. If you have any doubts about the installation, please contact us for clarification.

WARNINGS

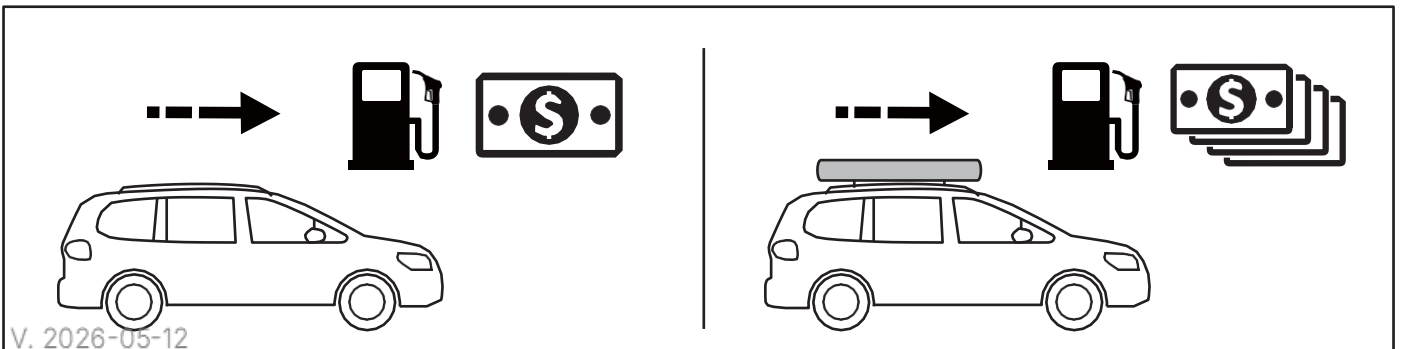
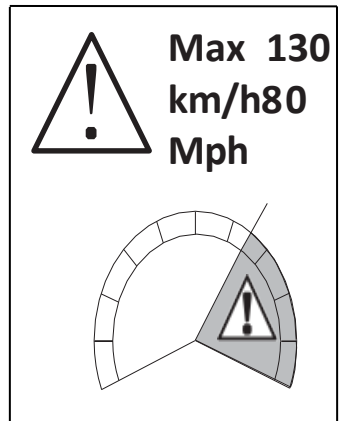
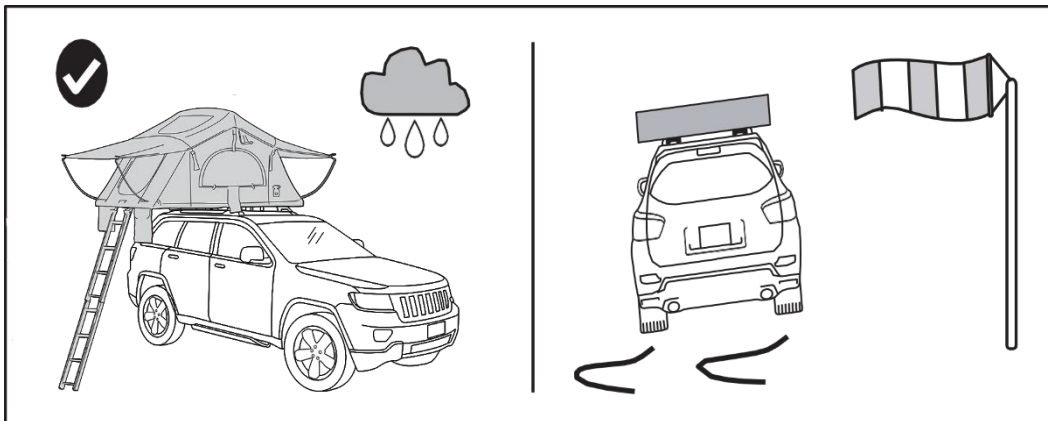
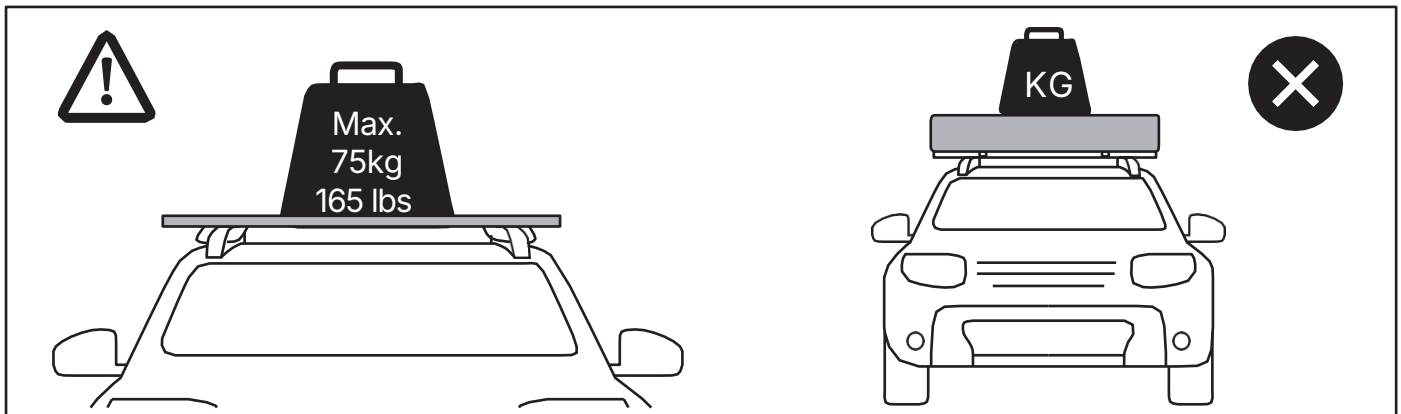
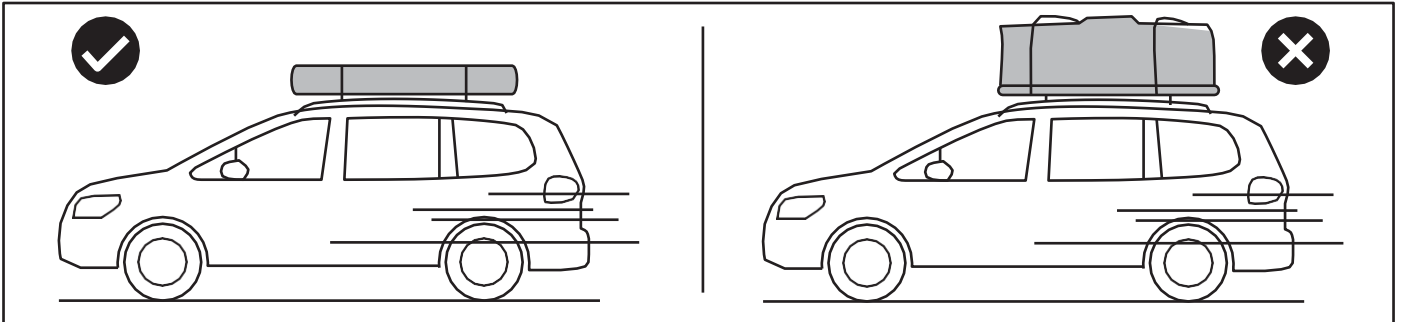
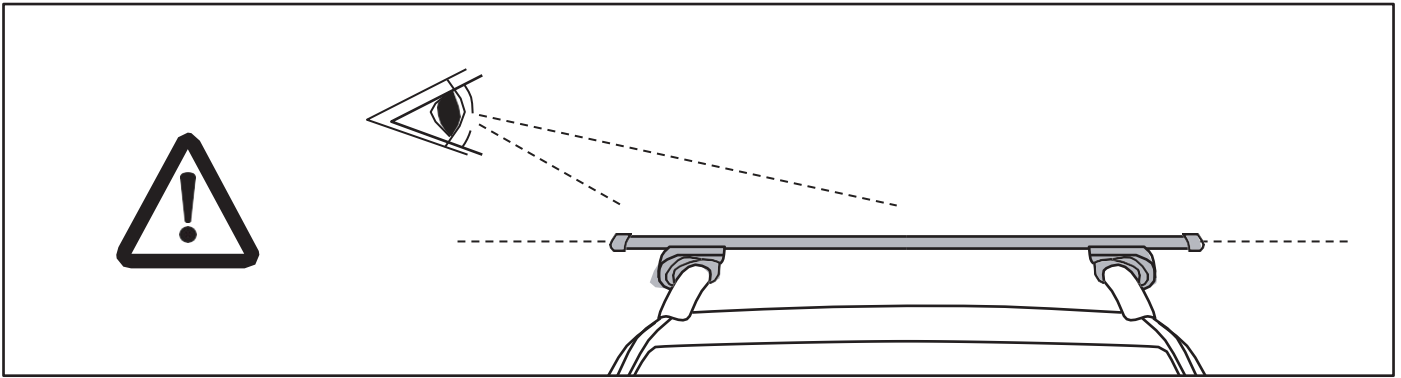

WARNINGS

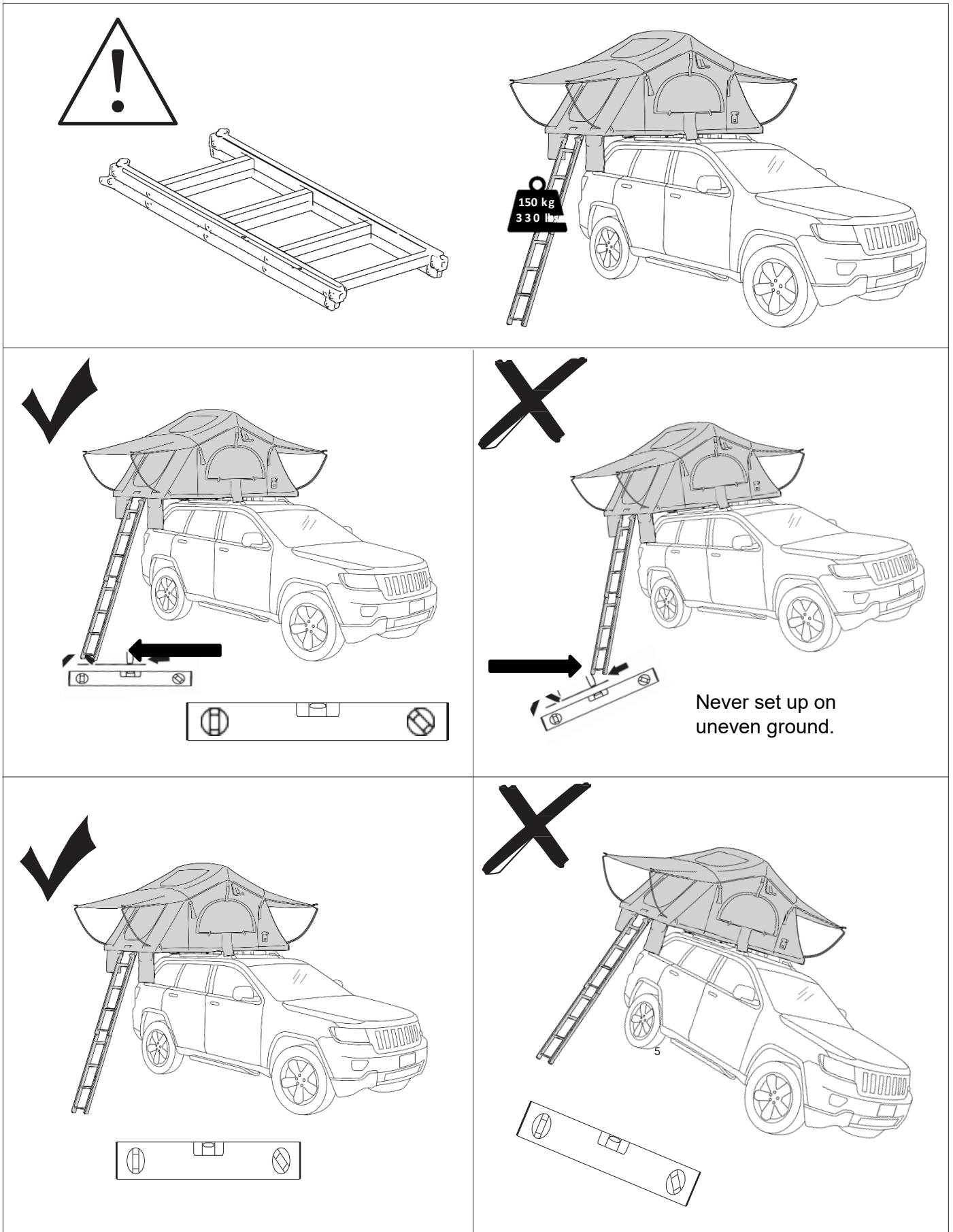

WARNINGS

Always position the tent with the wind hitting the rear, which is more aerodynamic

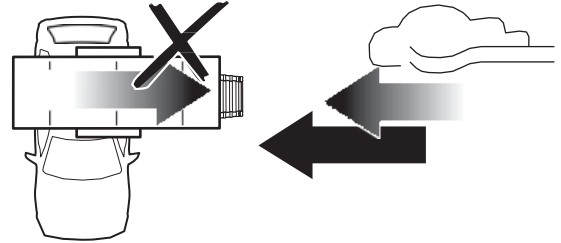
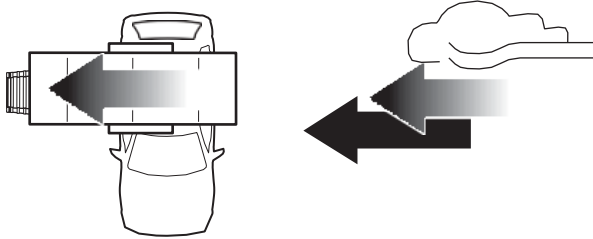

In a thunderstorm, do not stop on high ground exposed to lightning

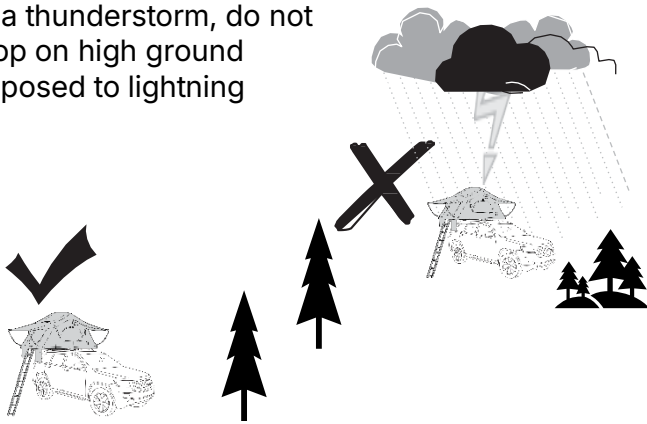

Max 60°C / 140°F

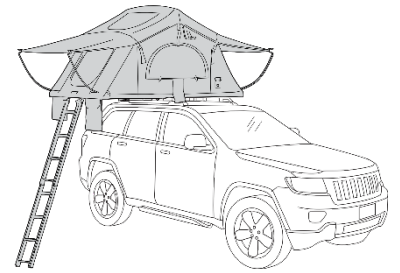

19 ft / 6 m



6 ft / 2 m



WARNING: KEEP ANY FLAMES AND ALL HEAT SOURCES

AWAY FROM THE TENT.

The fabric can burn if left in contact with any source of ignition.

BOX CONTENTS

A x2

B x2

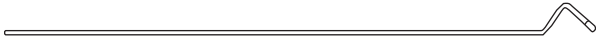

C x4

D x4

E x8

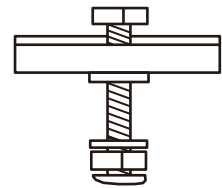
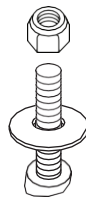

F x2

G x2-3

H x3

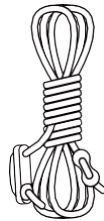
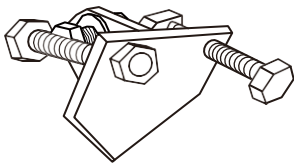

I x1

L x1

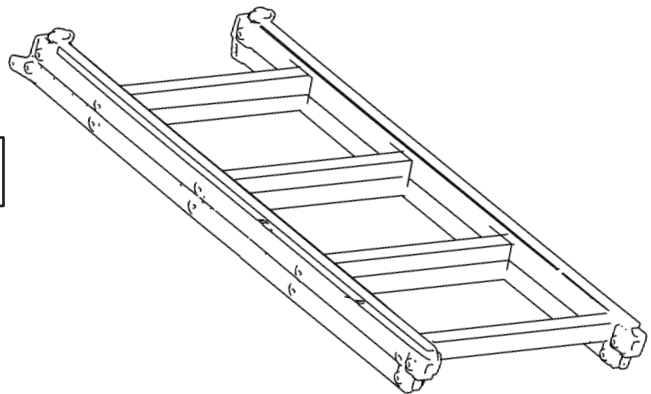
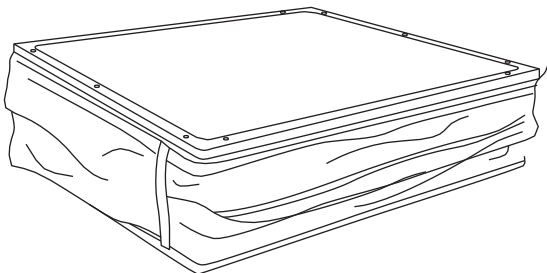

J x2

K x1

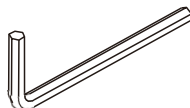
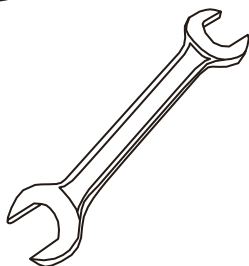

Before you start

Before starting assembly, make sure you have all the necessary components.

We recommend handling the product with care to avoid injury, damage to property and damage to the product itself.

Safety precautions

- Make sure you wear safety gloves and protective footwear.
- Some mounting systems and some vehicles are not suitable for carrying the weight of roof tents: do your research carefully before proceeding.
- We recommend the help of one or more people for manual assembly, or the use of suitable equipment.
- If you run into any difficulty, do not hesitate to contact us — we will advise you on the right assembly method.

Preparation

Place the tent on the packaging cardboard to protect it from scratches, then take out all the contents, including the mattress.

GROUND ASSEMBLY

- ① Turn the tent over and fix the two aluminium rails (B) using the M6 bolts, nuts and washers (D)

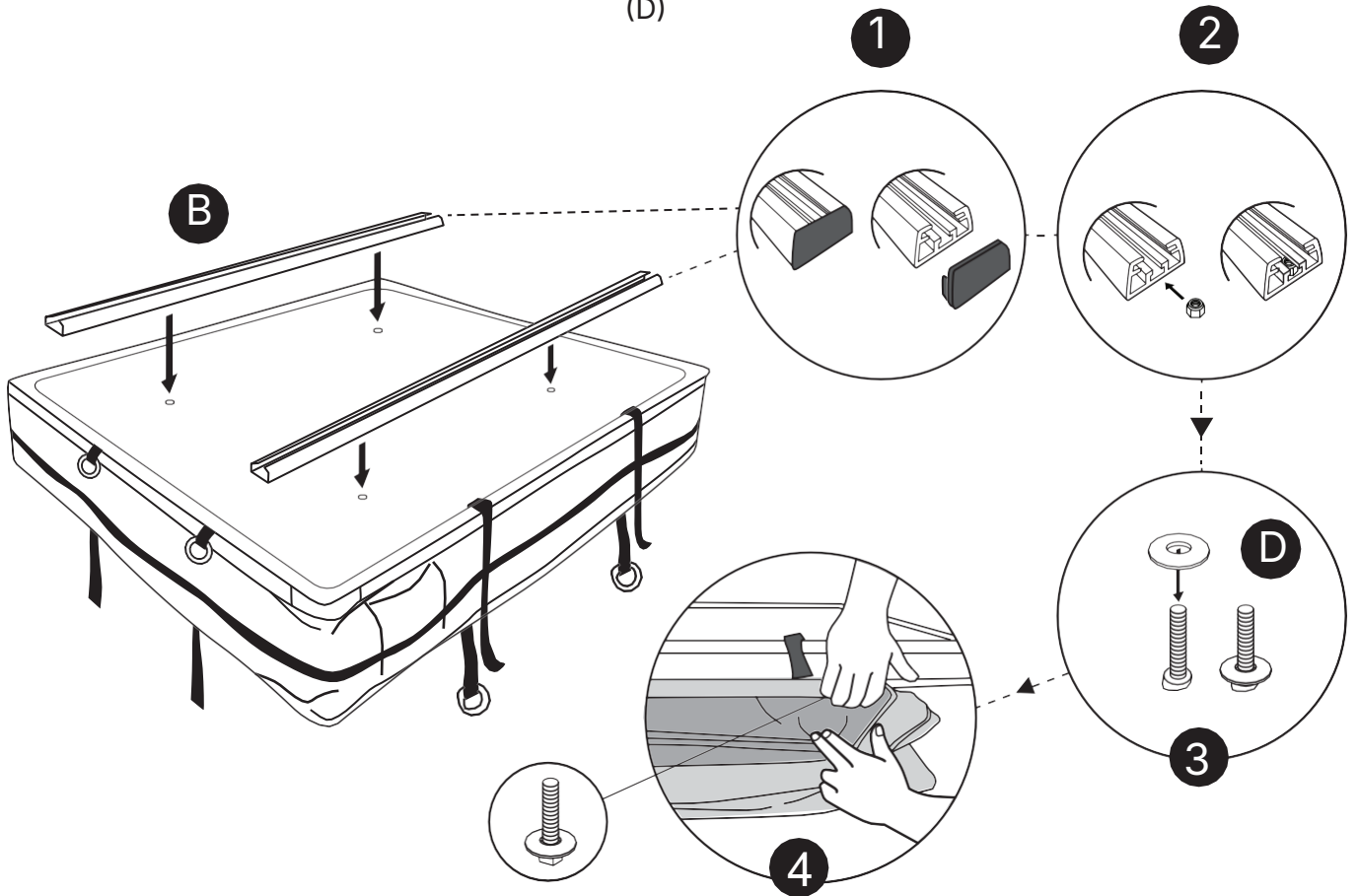

- ② Turn the tent right side up and install the ladder mounting brackets (F) and the telescopic ladder (L)

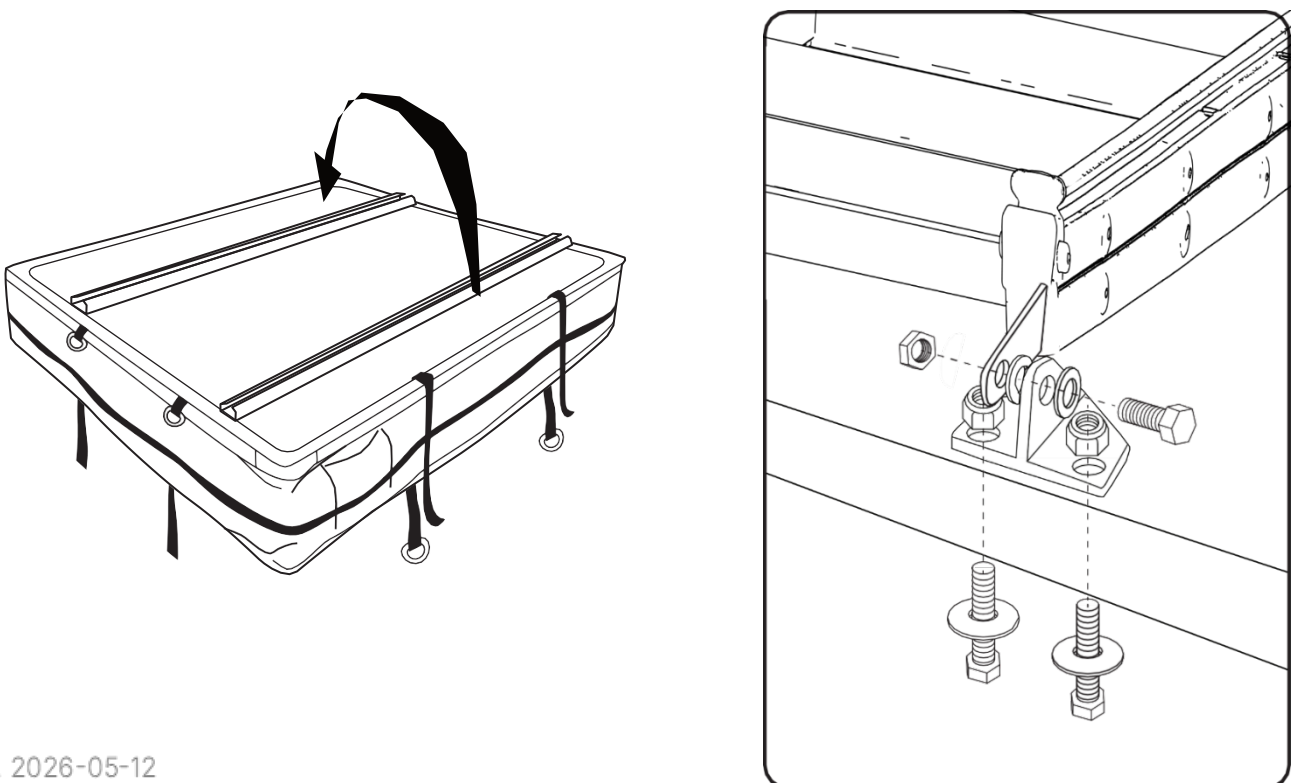

- ③ Take the soft black PVC cover and unzip it fully. Then slide the zip into the perimeter aluminium profile of the roof tent (1). Slide the PVC cover into the aluminium track on the mattress side (2)

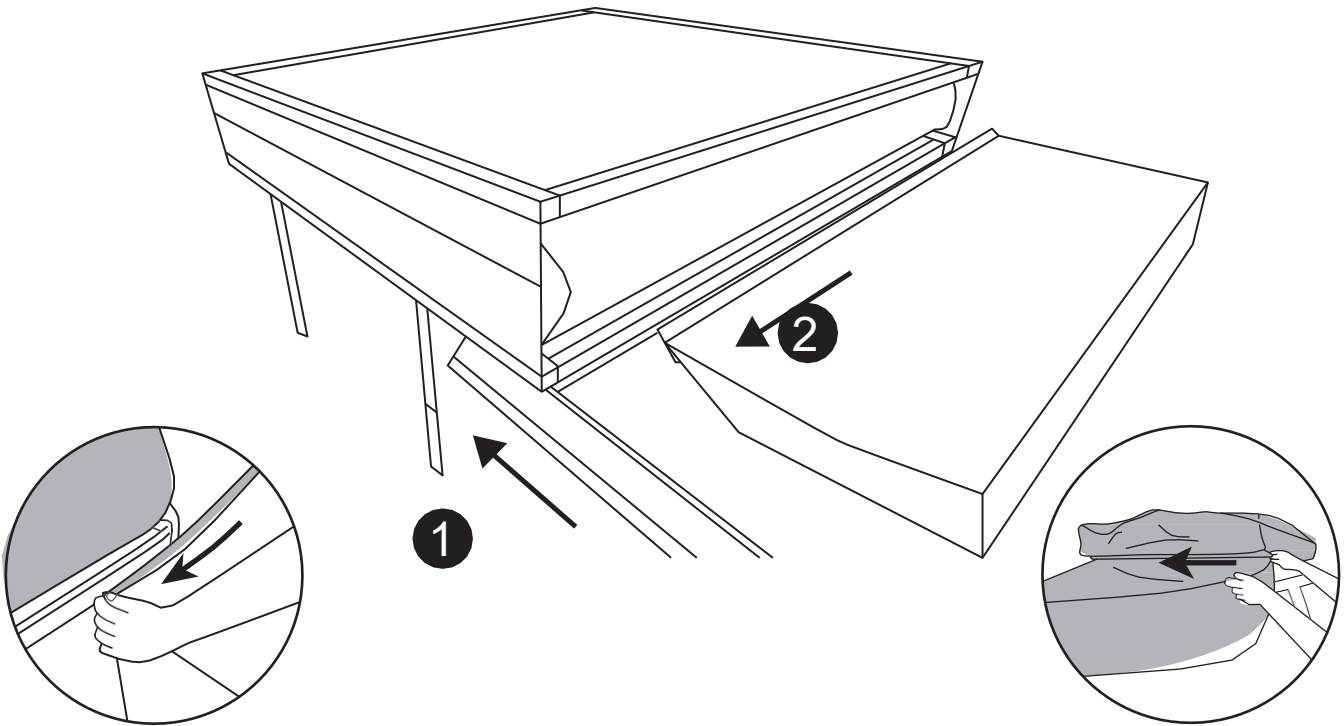

- ④ Cover the tent with the PVC cover and close it using the Velcro

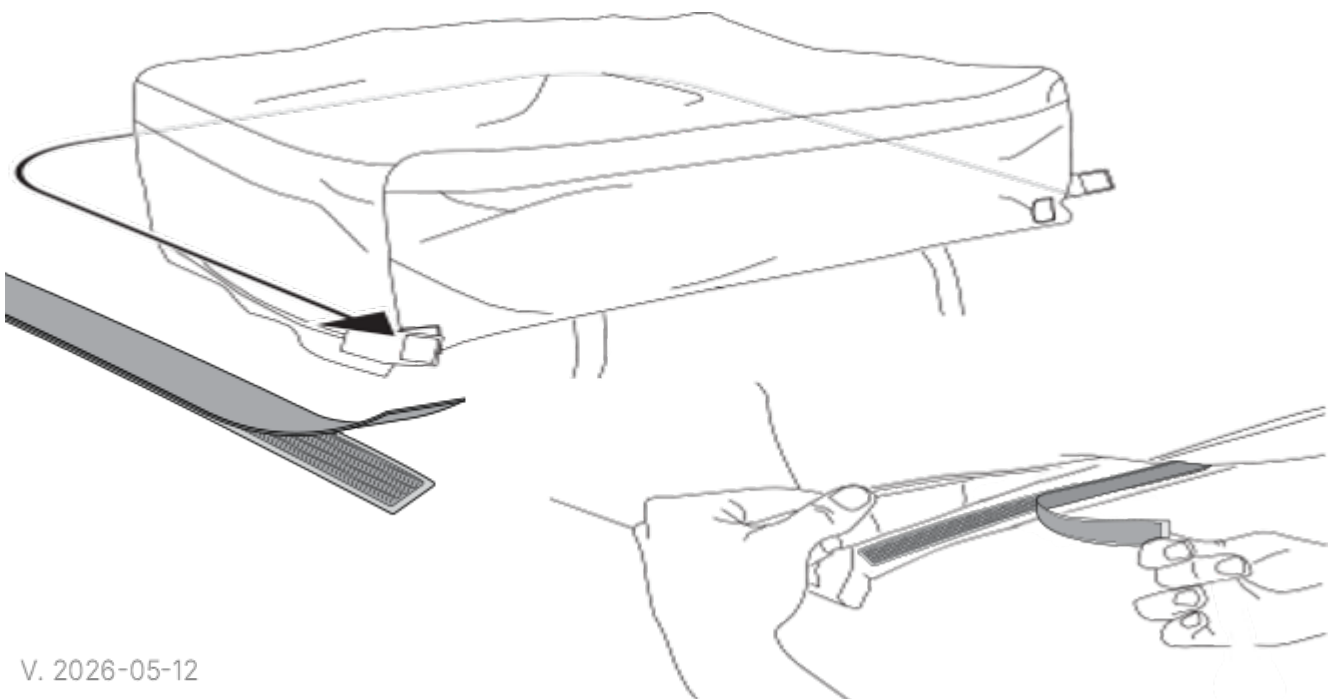

TENT ORIENTATION ON THE VEHICLE

You can choose to fit the tent sideways, or facing the rear or front of the vehicle.

The choice is usually dictated by the closed tent being wider than the vehicle's footprint.

If the tent is smaller, we recommend positioning the tent opening towards the busiest area of the vehicle, but never where you cook.

This will give a dual function of shelter and liveable space during normal daytime activities.

Before installing the tent, consider how your vehicle's rear doors open and the swing area required to open the tent.

Once the telescopic ladder has been extended, it must be pushed downwards to allow the tent to rotate on its hinged axis and open.

This movement requires care and a wide area to manoeuvre, so plan enough space for an easy, low-effort operation.

We recommend offsetting the tent on the car roof by at least 10–20 cm towards the side where you intend the tent to open, so the annex can be connected.

This may look unsightly, but it is needed for the product to work to its full potential. And if you wish, this offset will leave room to add a fantastic side-mounted Carcamp awning!

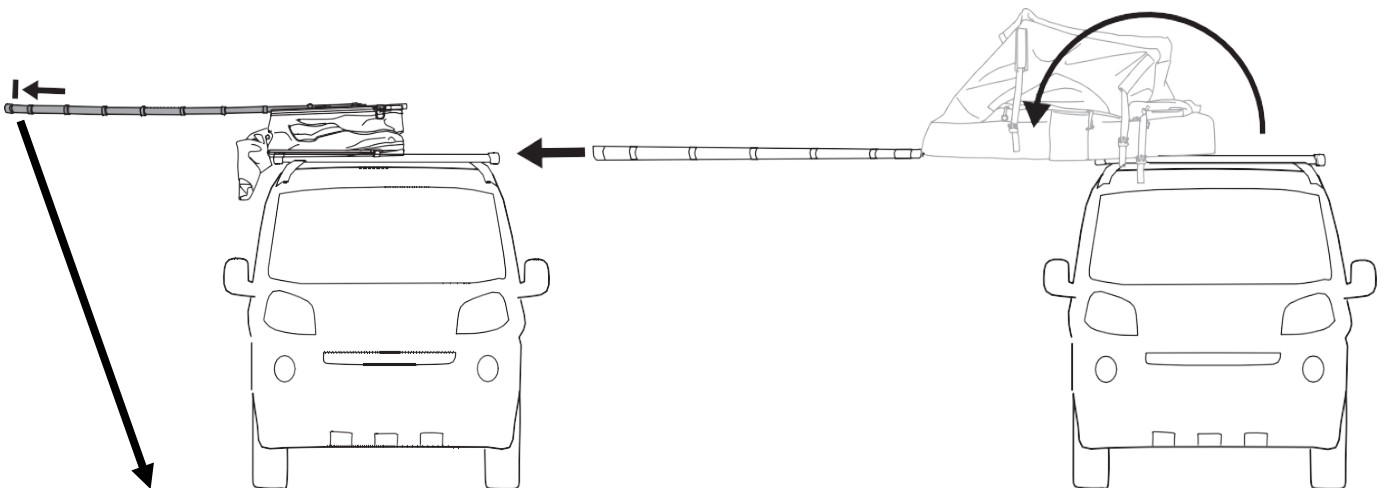

ATTACHING THE TENT TO THE VEHICLE

Pair each plate (E) with an M8 stainless steel bolt and slide the plate into the aluminium rail fixed under the tent, taking care to insert the plate correctly: both wings of the plate must sit in the dedicated groove as shown by the black arrows in the figure.

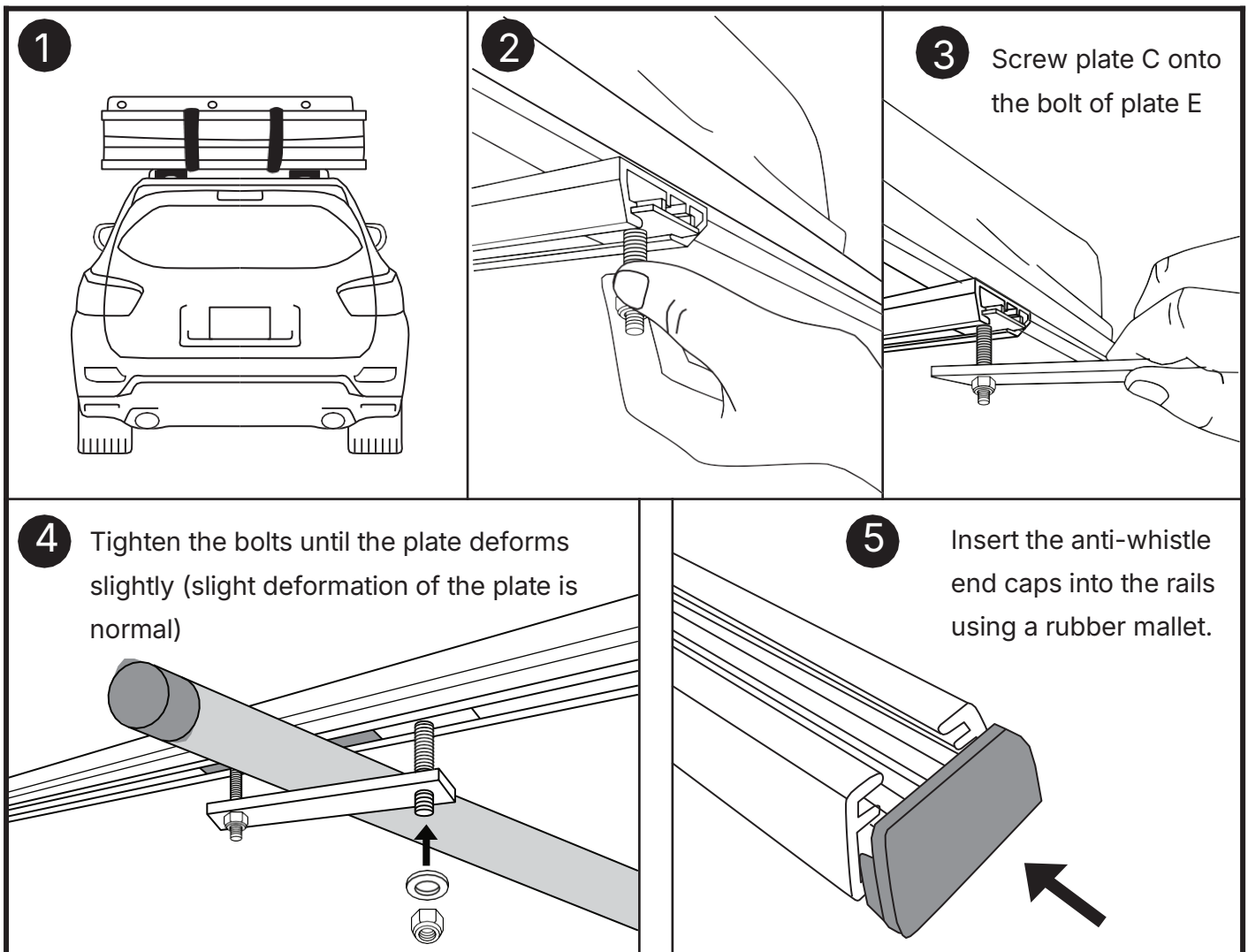
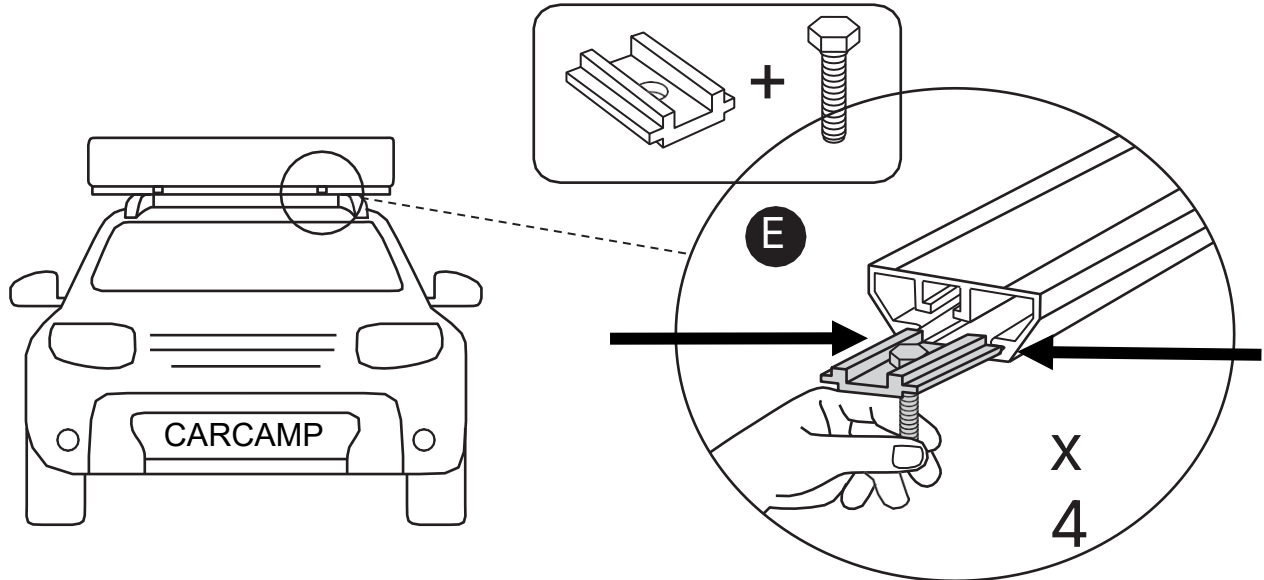



Need help?
Contact us

info@carcamp.it

1. Fully extend the ladder.
2. Listen for the repeated audible clicks that confirm each step has locked into place.
3. Once the ladder is extended, make sure all the steps are locked by pulling and pushing it firmly back and forth as if to close and reopen it.
4. If the ladder cannot be fully extended due to lack of space, you must first extend the lowest step and engage the two locking pins operated by the red buttons, and then extend the ladder always from the bottom upwards. Put simply, the last steps to be extended must be those at the top. If you proceed the other way round, the ladder will not lock and there is a serious risk of damaging the roof tent and injuring the user.

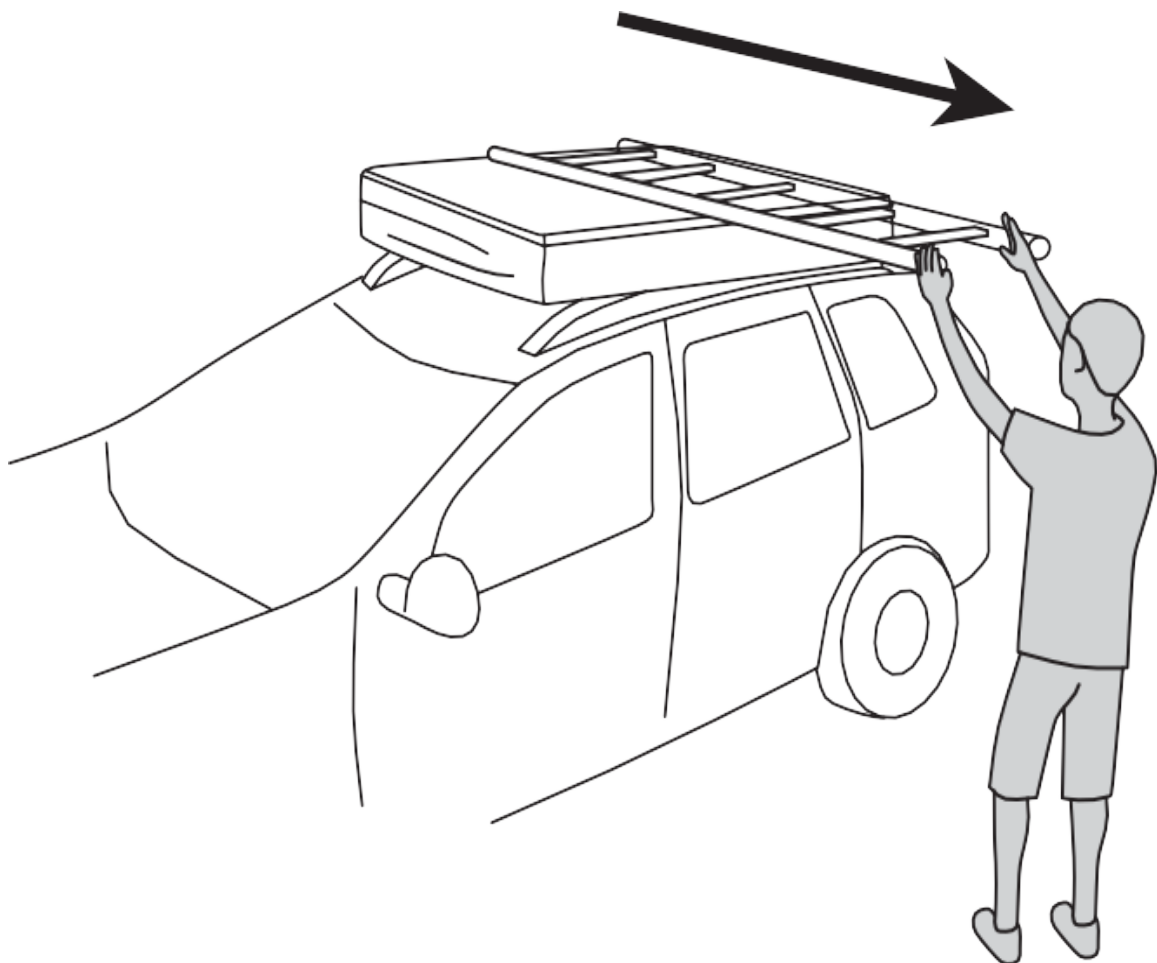

1. To close the ladder easily, we recommend fully extending it and then unlocking the first step by pressing both red buttons at the same time.
2. All the other steps with black buttons will be unlocked automatically as the rungs fold one above the other.
3. Secure the ladder with its velcro strap.
4. When transporting the roof tent on the road, it may be easier not to fasten the ladder with the velcro, to avoid having to climb on top of the tent to release and pull out the ladder.

Ladder troubleshooting

If a problem occurs with the telescopic ladder during operation, check the troubleshooting table below before calling customer service.

Fault symptom	Cause of the problem	Solution
When you climb the ladder, the step drops on one side	The ladder is not properly locked with both locking pins on each step	Fully extend the ladder and make sure the step is locked.

Ladder cleaning instructions

1. Make sure no sand is present in the support feet; if there is, remove the rubber feet and clear out all the sand before turning the ladder over.
2. Detach the ladder from the roof tent.
3. Turn the ladder upside down with the support feet facing up to prevent any dirt removed from getting into the telescopic tubes.
4. Use a sponge and a water spray bottle to remove any impurities.
5. Let the ladder dry in the sun and open air, fully extended.
6. Spray very small amounts of silicone spray onto a piece of paper and apply it to the telescopic tubes of the ladder.
7. Open and close the ladder repeatedly to lubricate the moving parts.
8. Fully extend the ladder and wipe off any excess lubricant, leaving it to dry in the sun.
9. Check that no lubricant or moisture remains on the ladder before storing or using it.

OPENING THE TENT ON THE VEHICLE

① Start by undoing the side quick-release hooks and the perimeter zip, then follow the next images

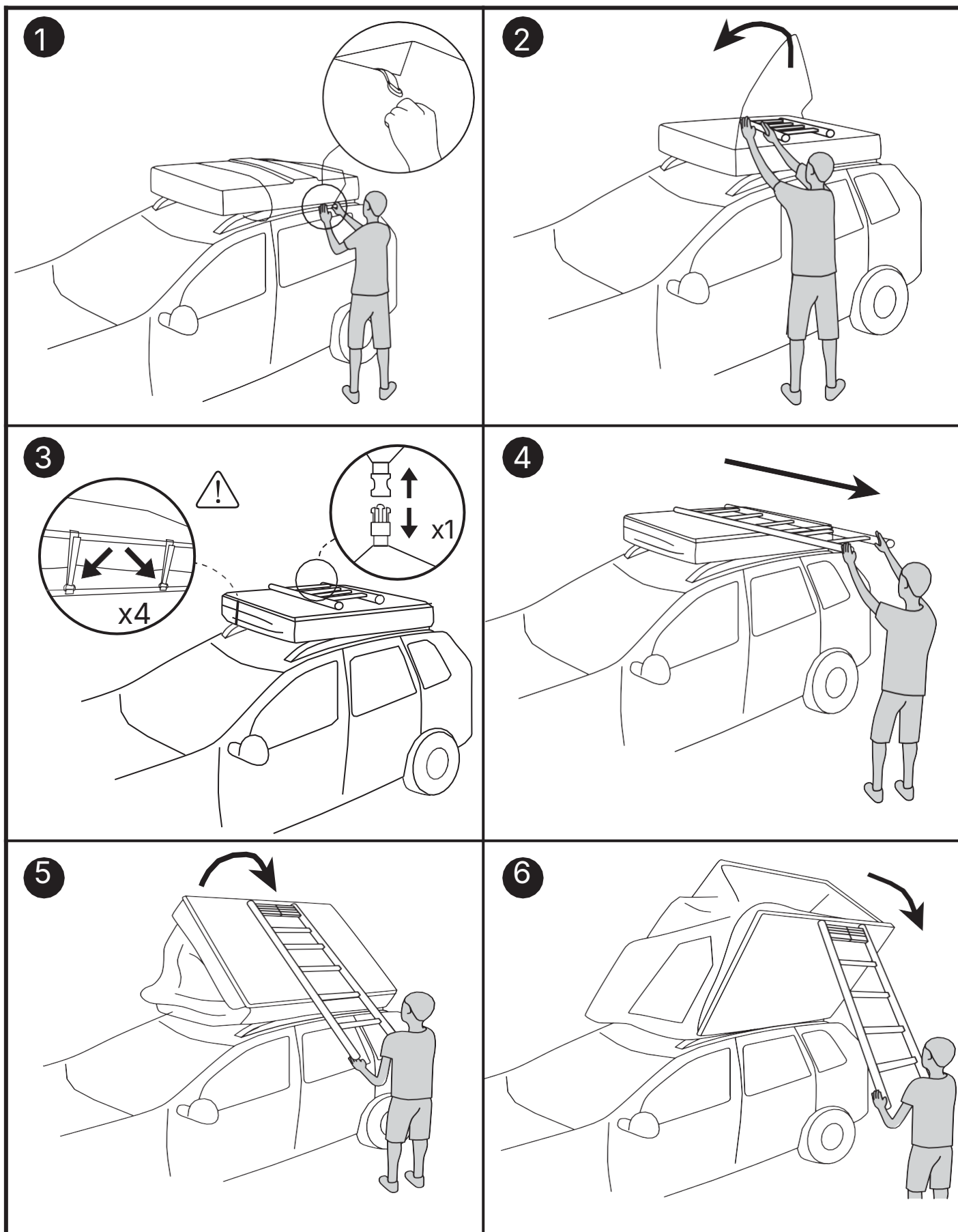

1



2



3



Before use

1. Make sure you are fit enough to use the ladder.
Certain medical conditions and / or the use of some medication, as well as alcohol or drug abuse, may cause the ladder to be used in an unsafe and non-compliant way. The maximum load capacity is 150 kg.
2. Inspect the ladder before use to check the condition and operation of all parts.
3. Visually check that the ladder is undamaged and safe to use every time you use it.
4. Remove any contamination from the ladder such as paint, lubricants, sand, mud or snow.

Positioning and extending the ladder

1. The ladder's angle must not exceed 75°. To check that the ladder is in the correct position, make sure the specially angled step is horizontal by comparing it with the surrounding horizon.
2. Before climbing the ladder, make sure both feet rest firmly on a flat, level and immovable surface.
3. The ladder must not be used on slippery surfaces (such as ice, polished or waxed surfaces, or significantly contaminated surfaces) unless effective safety measures are taken to prevent the ladder from slipping or unless the contaminated surfaces are sufficiently clean.

Using the ladder

1. Never exceed the maximum load of 150 kg.
2. Do not use the ladder in adverse weather conditions that could compromise its locking.
3. Take precautions to prevent children from playing on, under and around the ladder.
4. Always come down the ladder facing it and keeping a secure grip.
5. Maintain a secure grip on the ladder when going up and down.
6. Do not use the ladder as a bridge.
7. Wear suitable footwear when using the ladder.
8. Avoid excessive side loading.
9. Do not climb the ladder with your hands occupied by other objects; keep your hands firmly on the ladder.

① Fit the elastic metal poles (A) into the rear rainfly and, on first use, adjust the tension of the 10 or 11 quick-clip ties that hold the upper rainfly fabric in position.

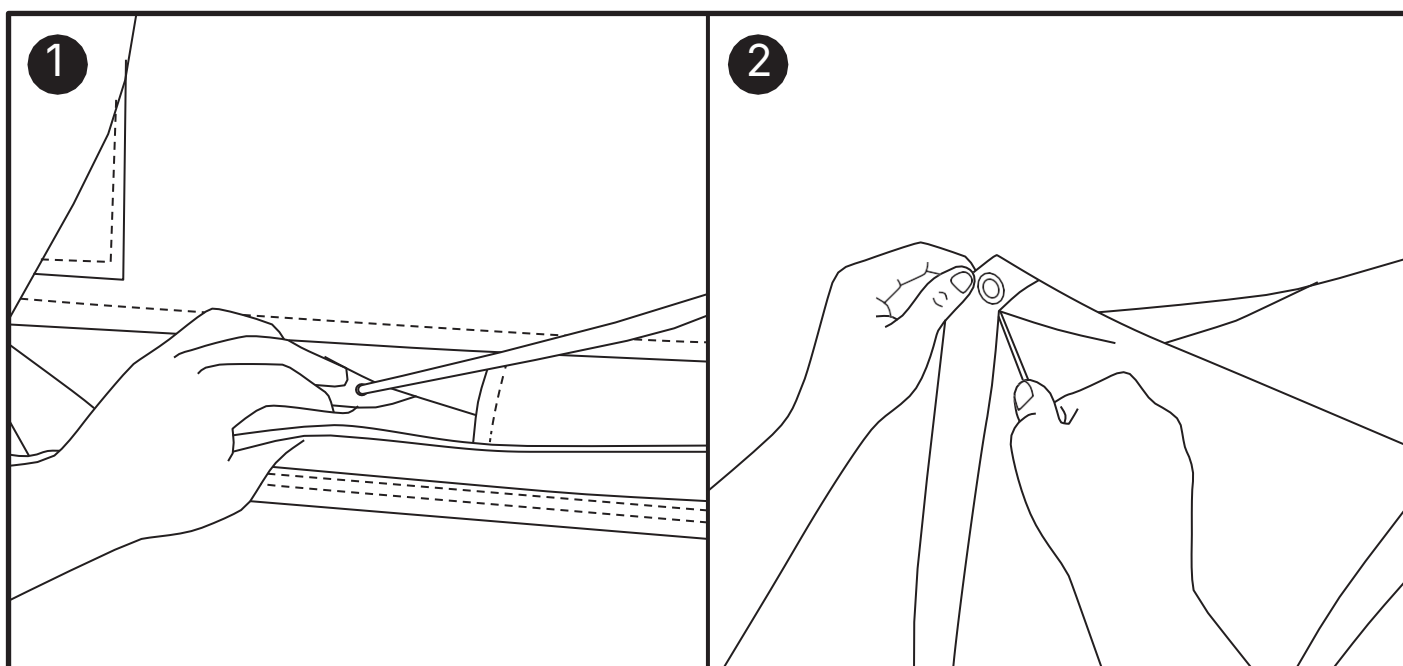
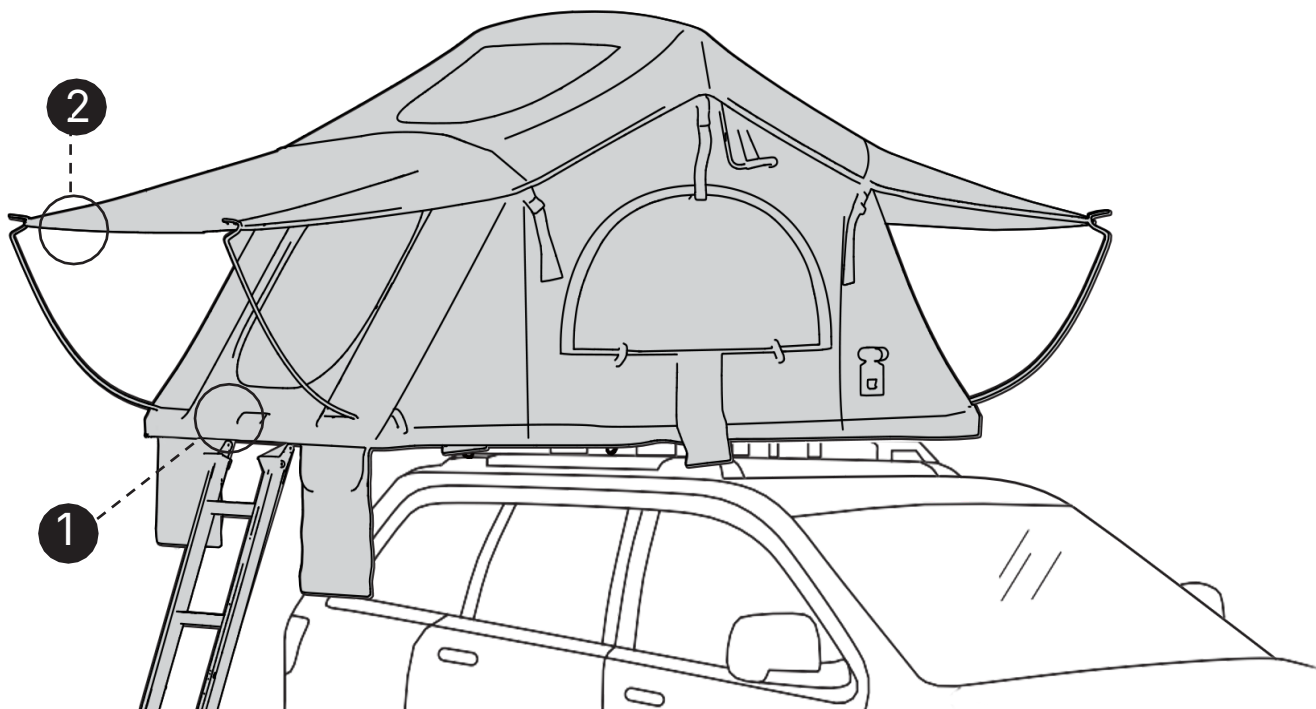

You will find the metal poles in the inner pocket as soon as you enter the tent.



Alternatively, you can roll up the rainfly fabric to make pitching and packing down quicker.

The two options are shown below:



1. The tent can be closed by one person, but to make the closing operation easier we recommend doing it with two people.

Before closing the tent, remember to keep the upper and side window blackouts open by at least 40% of their capacity. This will allow air to escape more easily from the roof tent, preventing overpressure that would cause it to inflate and resist the closing operation.

The main role of the second person helping to stow the tent in its travel position is to help the rainfly fabric fold correctly.

While the main operator slowly manoeuvres the tent using the telescopic ladder as a lever, the second helper should be on the opposite side from the ladder (i.e. at the rear of the tent) and gently guide the rainfly fabric inwards into the roof tent by hand.

2. Remember to fasten the inner elastic ties by crossing them over so the fabric folds correctly. The inner ties should be slightly tensioned, but not pulled as tight as violin strings, to prevent water seeping in through the seams of the inner hooks.

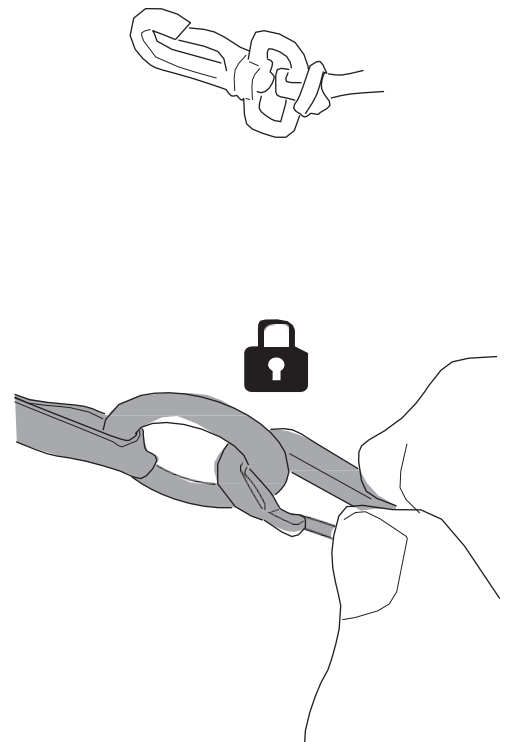
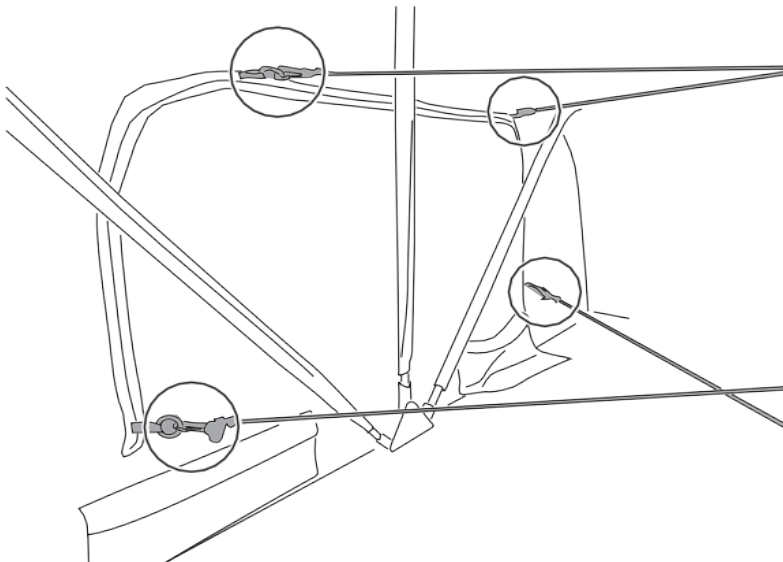

3. We recommend fully closing all the annex windows and mosquito nets before unzipping it, to prevent the fabric from twisting on itself.
4. If you cannot let the tent dry in the morning and the fabric is wet after a stormy night or heavy dew, we recommend gently shaking the fabric from the inside to make the pooled water run off. Do not rub the outer surface to dry the water, as this will compromise the fabric's water-repellent performance.
5. Within at most 1 day of closing the tent damp or wet, we recommend opening it for at least 3 hours in excellent weather conditions to dry the fabric and prevent mould or other unpleasant problems. To maximise drying, a heater that blows warm air inside and removes moisture can be inserted into the dedicated side slot in the tent body. The sun and natural wind, however, remain the best method.

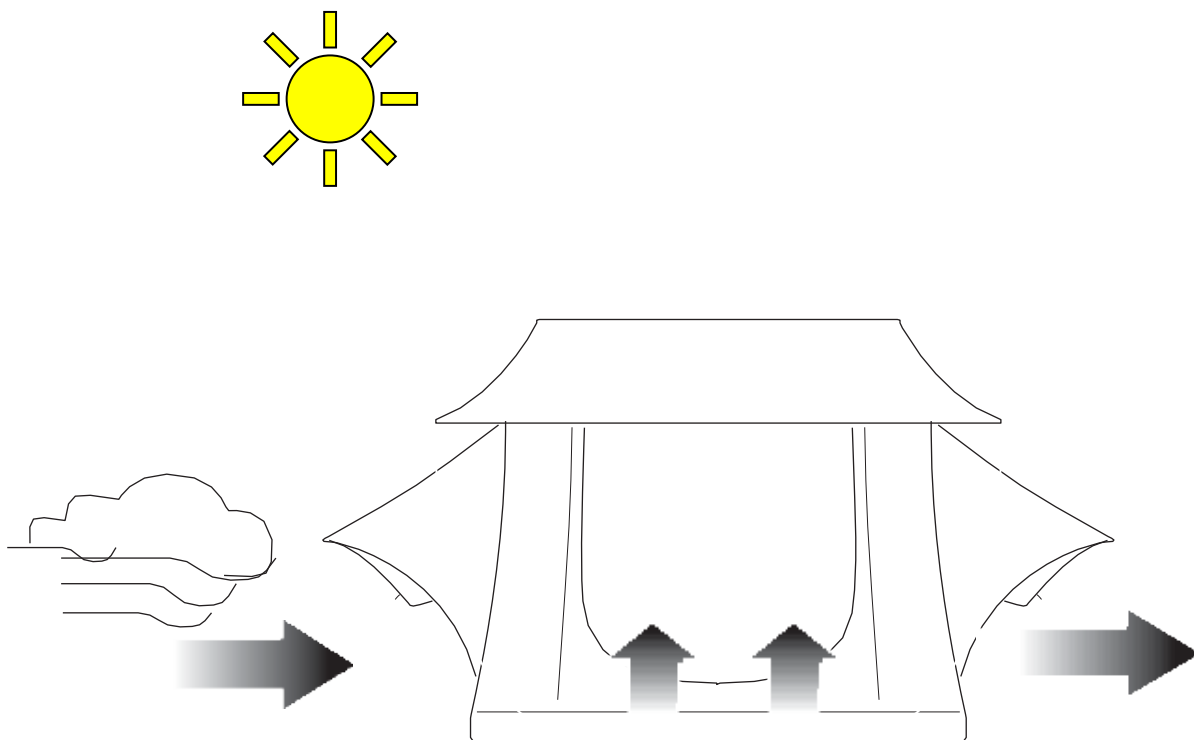

1. When the product is not in use, we recommend storing it indoors and away from sources of light, heat and moisture. Otherwise, enjoy your product as often as you like — normal wear and tear will not spoil your holidays.
2. In any case, we recommend always storing your product in a moisture-free environment to prevent mould.
3. We recommend removing the mattress and storing it separately.
4. We recommend using silica desiccant bags inside the roof tent. Silica crystals are a practical and inexpensive solution we like to recommend against moisture (e.g. cat litter). We suggest placing them inside the roof tent in a sturdy fabric pouch that does not let the silica leak out, leaving them in for the entire winter or any period of disuse. This trick will keep the inside of the tent moisture-free.
5. You can store your precious roof tent in a number of ways; here are a few we recommend:
 - a) Position the tent horizontally, hanging it from the ceiling, taking care that the suspension straps do not rub against the winter cover and risk damaging it.
Before fixing it to the ceiling, take all due precautions and check the feasibility of your ceiling anchoring system. You are directly responsible for any malfunction or accident.
 - b) Place the tent on the side opposite the rotation hinge, protecting the contact with the floor using a soft material that insulates it from the floor, to prevent the soft cover from being damaged by impact, friction or simply by abnormal pressure on the protective PVC.



Silica crystals

1. Carry out routine maintenance every 6 months or after intensive use, taking care to inspect the following components:
 - a) Check the fixing bolts of the bars integrated into the roof tent.
 - b) Check that the hinges used to rotate the cantilevered platform of the vehicle are intact and correctly positioned.
 - c) Check the correct fixing of the ladder and of the anchoring brackets to the tent.
 - d) Check all visible bolts and nuts, both those used to fix the roof tent to the roof bars or rack and those used to fix the roof bars or rack to the vehicle.
 - e) Check all rivets and note any anomalies; in case of a suspected anomaly, please send as much photographic material as possible to carcamp.info@gmail.com.
 - f) Check the running of every zip; clean and lubricate with silicone spray, using a small brush for more effective cleaning, taking care not to stain the surrounding fabric.

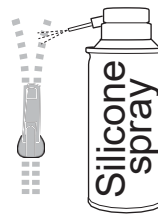

- g) Check the integrity of the outer PVC cover (in case of small holes or tears, contact us to obtain the Carcamp repair kit.)
- h) Remove the inner anti-condensation mesh and wash it with a water spray bottle.
- i) Vacuum any dust or other material that has accumulated under the anti-condensation mesh and clean the surface with a neutral detergent.
- j) Check the integrity of the transparent PVC (always handle with care).
- k) Clean off any dirt residue using only running or pressurised water.
- l) Never use pressure washers or machines with a pressure higher than 3 bar, and keep a minimum distance of 2 metres using a soft water jet.
- m) After a long period, it may be necessary to apply a water-repellent treatment to the entire fabric of the tent to help water droplets run off. Various products are available on the market; if in doubt, contact us and we will be happy to advise you.

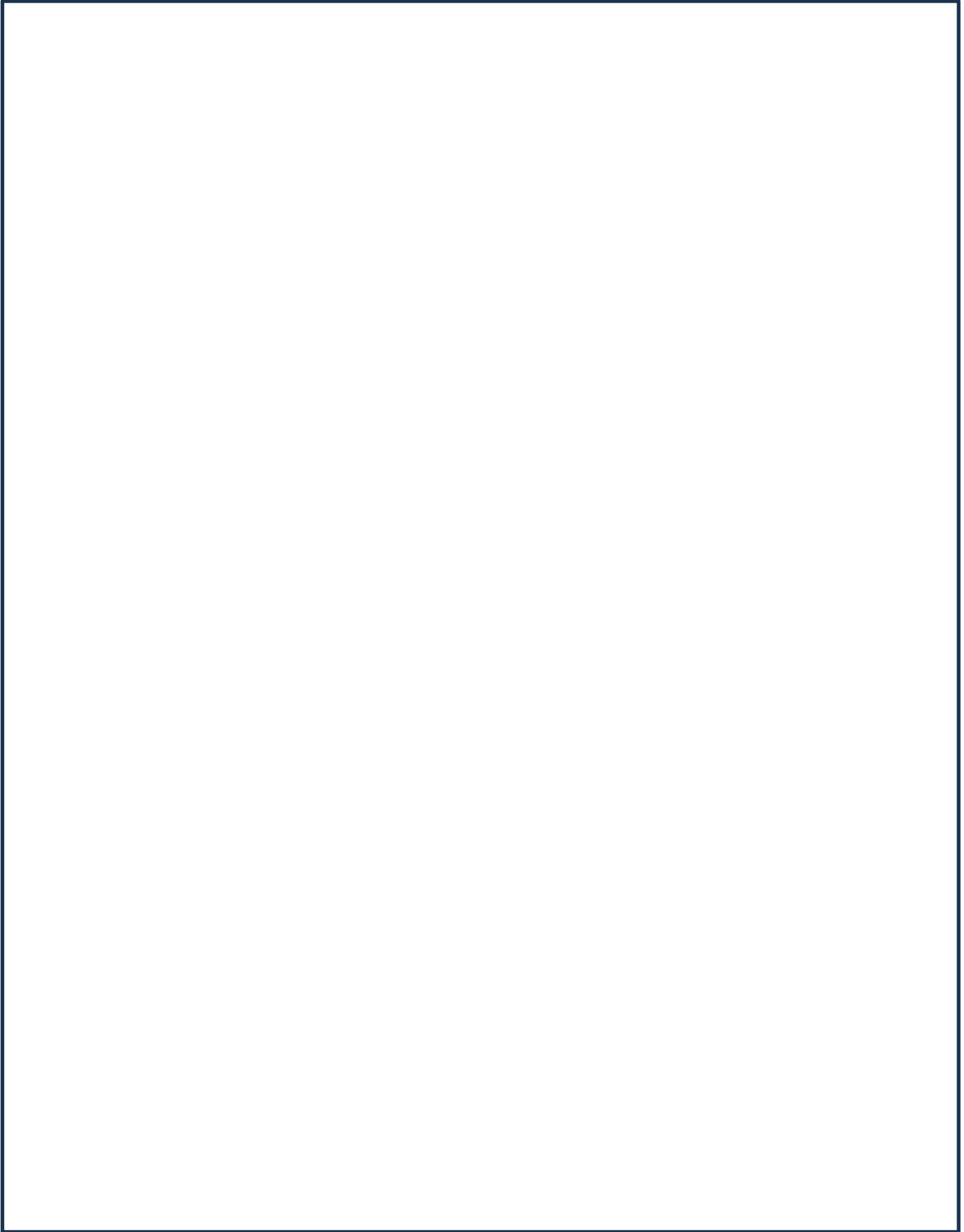

MEMORY & FEEDBACK

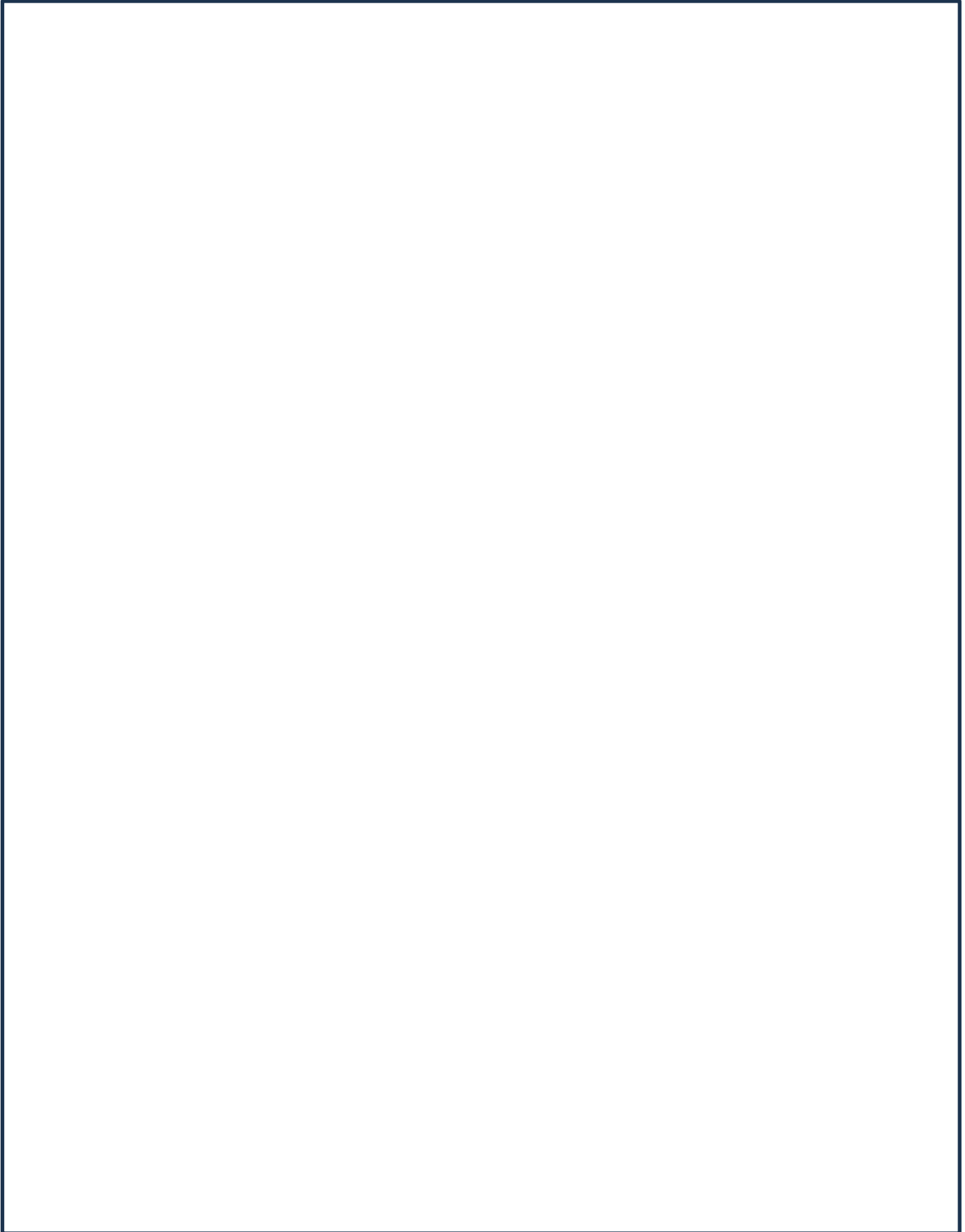

CARCAMP

Menabo Group



MADE IN PRC
ITALIAN DESIGN AND SOLUTIONS

Carcamp. Produced by F.lli Menabo s.r.l
Via 8 Marzo, 3
42025 Cavriago RE - Italy
(+39) 351 3085255
carcamp.it
info@carcamp.it